

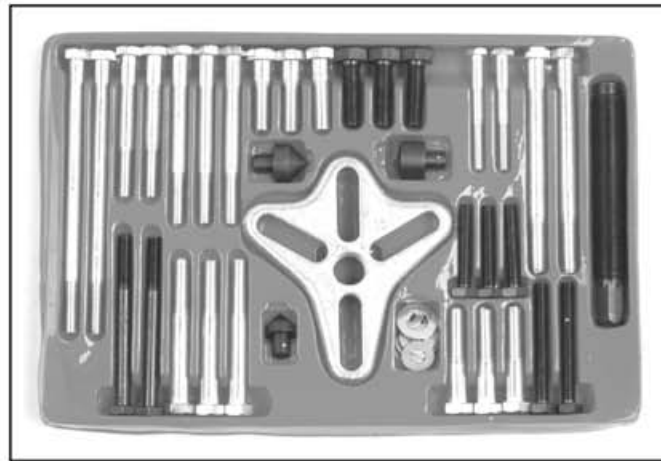

Assembly & Instruction Manual

46PC HARMONIC PULLER SET

Model 5174



Distributed Exclusively By



THANK YOU FOR BUYING CUMMINS INDUSTRIAL TOOLS
Your new Harmonic Puller Set has been engineered and manufactured to Cummins tools high standards for dependability, ease of operation, and operator safety. properly cared for, it will give you years of rugged, trouble-free performance

CAUTION: Carefully read through this entire operator's manual before using your new machine

Pay close attention to the Rules for Safe Operation, Warnings, and Cautions. If you use your machine properly and only for what it is intended, you will enjoy years of safe, reliable service.

SAVE THIS MANUAL FOR FUTURE REFERENCE



To reduce risk of injury, everyone using, installing, repairing, maintaining, changing accessories on, or working near this tool must read and understand these instructions before performing any such task.

Customer Service Postal Address:
1290 35 Road
Minden, NE 68959
voice: 1-(308) 832-2070
fax: 1-(308) 832-2069

*You can purchase additional
items at www.cumminstools.com*

Safety Warnings and Precautions

WARNING: When using tool, basic safety precautions should always be followed to reduce the risk of personal injury and damage to equipment.

Read all instructions before using this tool!

1. **Keep work area clean.** Cluttered areas invite injuries.
2. **Observe work area conditions.** Do not use machines or power tools in damp or wet locations. Don't expose to rain. Keep work area well lighted.
3. **Keep children away.** Children must never be allowed in the work area. Do not let them handle machines, tools, or extension cords.
4. **Store idle equipment.** When not in use, tools must be stored in a dry location to inhibit rust. Always lock up tools and keep out of reach of children.
5. **Use the right tool for the job.** Do not attempt to force a small tool or attachment to do the work of a larger industrial tool. There are certain applications for which this tool was designed. It will do the job better and more safely at the rate for which it was intended. Do not modify this tool and do not use this tool for a purpose for which it was not intended.
6. **Dress properly.** Do not wear loose clothing or jewelry as they can be caught in moving parts. Protective, electrically non-conductive clothes and non-skid footwear are recommended when working. Wear restrictive hair covering to contain long hair.
7. **Use eye protection.** Always wear ANSI approved impact safety glasses underneath a full face shield during use. Also, wear heavy duty work gloves.
8. **Do not overreach.** Keep proper footing and balance at all times. Do not reach over or across running machines.
9. **Maintain tools with care.** Keep tools sharp and clean for better and safer performance. Follow instructions for lubricating and changing accessories. The handles must be kept clean, dry, and free from oil and grease at all times.
10. **Remove adjusting keys and wrenches.** Check that keys and adjusting wrenches are removed from the tool or machine work surface before starting work.
11. **Stay alert.** Watch what you are doing, use common sense. Do not operate any tool when you are tired.
12. **Check for damaged parts.** Before using any tool, any part that appears damaged should be carefully checked to determine that it will operate properly and perform its intended function. Any part that is damaged should be replaced.
13. **Replacement parts and accessories.** When servicing, use only identical replacement parts. Use of any other parts will void the warranty. Only use accessories intended for use with this tool. Approved accessories are available from Cummins Industrial Tools.
14. **Do not operate tool if under the influence of alcohol or drugs.** Read warning labels on prescriptions to determine if your judgment or reflexes are impaired while taking drugs. If there is any doubt, do not operate the tool.

Warning: The warnings, cautions, and instructions discussed in this instruction manual cannot cover all possible conditions and situations that may occur. It must be understood by the operator that common sense and caution are factors which cannot be built into this product, but must be supplied by the operator.

THANK YOU for choosing a **CUMMINS INDUSTRY TOOLS** product. For future reference, please complete the owner's record below:

Model _____ Serial No _____ Purchase Date _____

SAVE THE RECEIPT, WARRANTY AND THESE INSTRUCTIONS. It is important that you read the entire manual to become familiar with the unit BEFORE you begin assembly.



READ ALL INSTRUCTIONS BEFORE USING THIS PRODUCT!

The Operator

COMMON SENSE AND CAUTION ARE FACTORS WHICH CANNOT BE BUILT INTO ANY PRODUCT. THESE FACTORS MUST BE SUPPLIED BY THE OPERATOR. PLEASE REMEMBER:

Do not use the product if under the influence of alcohol or drugs. Read warning labels on prescriptions to determine if your judgment/reflexes might be impaired.

Do not wear loose clothing or jewelry as they can be caught in moving parts.

Protective gloves and non-skid footwear is recommended.

Wear restrictive hair covering to contain long hair.

Use eye and ear protection. Always wear: ANSI-approved impact safety goggles.

Maintain proper footing and balance at all times.

Work Area

TO AVOID RISK OF PERSONAL INJURY, EQUIPMENT DAMAGE, FIRE AND SHOCK, MAKE SURE YOUR WORK AREA IS:

Free of damp, wet or rainy conditions

Free of children (never let them handle tools or machinery)

Well-lit

Clean and uncluttered

Before Operating

Before using any tool, any part that appears damaged should be carefully checked to determine that it will operate properly and perform its intended function.

Before using your Bolt Puller set check for damaged parts.

IF THERE IS ANY QUESTION ABOUT A CONDITION BEING SAFE OR UNSAFE, DO NOT OPERATE THE TOOL.

Technical Specifications

| | |
|--------------------------|---|
| Tool Name: | Bolt Puller Set |
| SKU: | #37714 |
| Number of pieces: | 46 |
| Set includes: | 2 and 3 way yoke, pressure screw, 1" adapter, large tapered adapter, assorted silver studs, assorted washers, assorted black studs, small tapered adapter, grade 5 bolts. |
| Product Use: | The Bolt Puller Set can be used for a variety of pulls such as removing harmonic balancers, gear pulleys, steering wheels, wall plates and crank shafts. |

Assembly

Your Bolt Puller Set comes unassembled. It is important that you read the entire manual to become familiar with the unit **BEFORE** you use the Bolt Puller. Before assembling your Bolt Puller, be sure that you have all parts described in the Parts List on page 4.

Assemble attachments based on the intended use of the Bolt Puller .

Assemble and disassemble your Bolt Puller set for each use. Put back all pieces in the box provided and store in the box to ensure that no pieces are lost.

Operation

- Step 1)** Screw Pressure Screw (part # 2) into the Yoke (part #1) with raised side of the Yoke facing you and flat side facing item to be pulled. Screw Pressure Screw in far enough so that open end is reachable.
- Step 2)** Choose the adapter (part #3, #4, or #5) which best rests securely on the center portion of the item to be pulled. Note that each adapter is differently shaped in order to sit flush and stable with the item to be pulled. Attach the adapter to the Pressure Screw (part #2) by pushing it into the hole at the end of the Pressure Screw.
- Step 3)** Insert Bolts of correct size (see Parts List on page 4) through Yoke (part #1) and into object to be pulled. Use wrench to turn Pressure screw (part # 2) clockwise. This will cause Bolts to pull upward. Continue to turn Pressure Screw until item has been successfully pulled.

BOLT PULLER SET, 46 PC

#37714

Parts Diagram

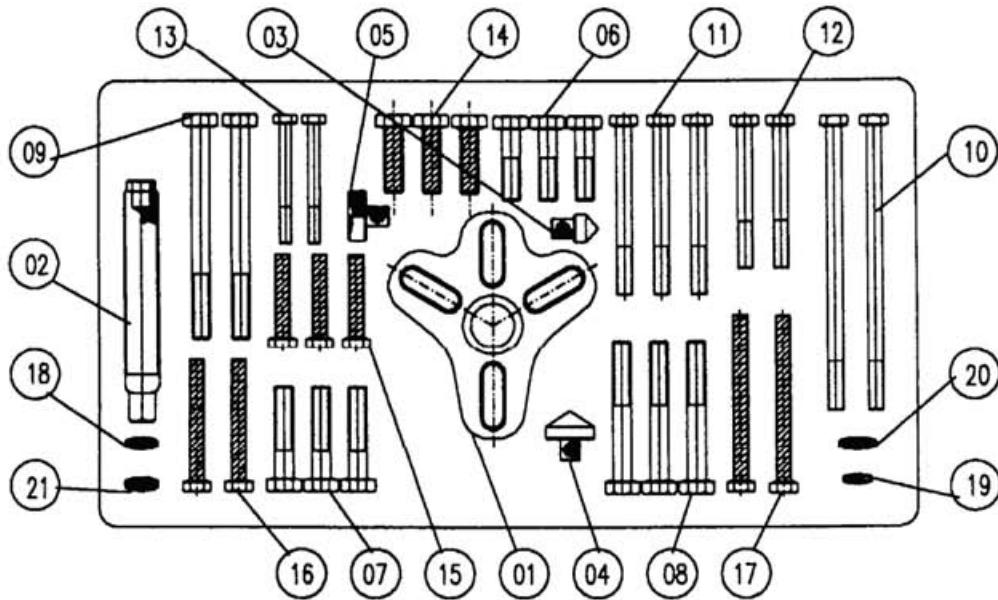

Parts List

| Part Number | Description | Quantity |
|-------------|-----------------------------|----------|
| 1 | Yoke | 1 |
| 2 | 5" Pressure Screw | 1 |
| 3 | Small Adapter | 1 |
| 4 | Large Adapter | 1 |
| 5 | Flat Shaft Adapter | 1 |
| 6 | 1-1/2" Bolt, 3/8" - 24 | 3 |
| 7 | 2" Bolt, 3/8" - 16 | 3 |
| 8 | 3" Bolt, 3/8" - 16 | 3 |
| 9 | 4-1/2" Bolt, 3/8"-16 | 2 |
| 10 | 6" Bolt, 5/16"- 18 | 2 |
| 11 | 3-1/2" Bolt, 5/16"-18 | 3 |
| 12 | 3" Bolt, 5/16" - 24 | 2 |
| 13 | 2-1/2" Bolt, 1/4" - 28 | 2 |
| 14 | 35 mm Bolt/ 1.4", M10 x 1.5 | 3 |
| 15 | 45 mm Bolt/ 1.8", M8 x 1.25 | 3 |
| 16 | 65 mm Bolt/ 2.6", M8 x 1.25 | 2 |
| 17 | 90 mm Bolt/ 3.6", M8 x 1.25 | 2 |
| 18 | 5/16" ID Washer | 3 |
| 19 | 1/4" ID Washer | 2 |
| 20 | 10 mm/.25" ID Washer | 3 |
| 21 | 8 mm/.32" ID Washer | 3 |