

SAFETY WARNINGS AND PRECAUTIONS

WARNING: When using tool, basic safety precautions should always be followed to reduce the risk of personal injury and damage to equipment. Read all instructions before using the tool!

- **Work area conditions.** Cluttered areas invite injuries.
- **Additional work area conditions.** Do not use machines or power tools in damp or wet locations. Do not expose to rain. Keep work area well lighted.
- **Keep children away.** Children must never be allowed in the work area. Do not let them handle machines, tools or extension cords.
- **Store idle equipment.** When not in use, tools must be stored in a dry location to inhibit rust. Always lock up tools and keep out of reach of children.
- **Use the right tool for the job.** Do not attempt to force a small tool or attachment to do the work of a larger industrial tool. There are certain applications for which this tool was designed. It will do the job better and more safely at the rate for which it was intended. Do not modify this tool and do not use this tool for a purpose for which it was not intended.
- **Dress properly.** Do not wear loose clothing or jewelry as they can be caught in moving parts. Protective, electrically non-conductive clothes and non-skid footwear are recommended when working. Wear restrictive hair covering to contain long hair.
- **Use eye protection.** Always wear ANSI approved impact safety glasses underneath a full face shield during use. Also, wear heavy duty work gloves.
- **Do not overreach.** Keep proper footing and balance at all times. Do not reach over or across running machines.
- **Maintain tools with care.** Keep tools sharp and clean for better and safer performance. Follow instructions for lubricating and changing accessories. The handles must be kept clean, dry, and free from oil and grease at all times.
- **Remove adjusting keys and wrenches.** Check that keys and adjusting wrenches are removed from the tool or machine work surface before starting work.
- **Stay alert.** Watch what you are doing, use common sense. Do not operate any tool when you are tired.
- **Check for damaged parts.** Before using any tool, any part that appears damaged should be carefully checked to determine that it will operate properly and perform its intended function. Any part that is damaged should be replaced.
- **Replacement parts and accessories.** When servicing, use only identical replacement parts. Use of any other parts will void the warranty. Only use accessories intended for use with this tool. Approved accessories are available from Cummins Industrial Tools.
- **Do not operate tools if under the influence of alcohol or drugs.** Read warning labels on prescriptions to determine if your judgment or reflexes are impaired while taking drugs. If there is any doubt, do not operate the tool.

WARNING: The warnings, cautions, and instructions discussed in this instruction manual can not cover all possible conditions and situations that may occur. It must be understood by the operator that common sense and caution are factors which can not be built into this product, but must be supplied by the operator.

OPERATING INSTRUCTIONS

Specifications

■ Max. Capacity	1,500 lbs
■ Overall Length	36"
■ Overall Width	25"
■ Min. Height	4"
■ Max. Height	17"

Contents Of Carton

DESCRIPTION	QTY
Frame Base	1
Hydraulic Ram	1
Foot Pedal Assembly	1
Pulling Handle	1

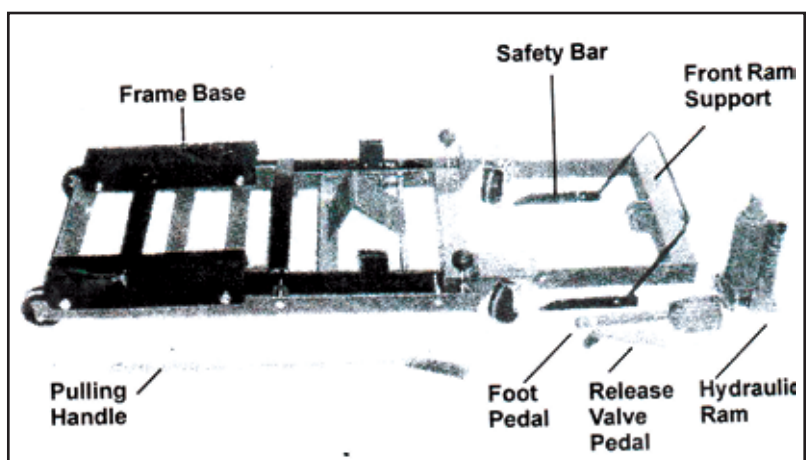

Assembly Instruction Diagrams

■ FIGURE 1

Secure the Hydraulic Ram to the base frame with two screws.



■ FIGURE 2

Insert the foot pedal into the over the pump piston and secure it with a screw.

Insert a pivot pin through the two holes in front of the Release Valve and through the Release Valve pedal. Secure it with a R-pin.

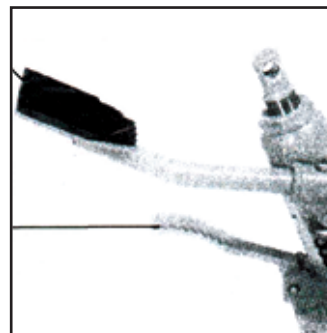

OPERATING INSTRUCTIONS

■ FIGURE 3

Place the Safety Bar and washer inside the Front Ram Support and align then with holes on the frame. Insert bolt through the three of them and using washer & R-pin on set.

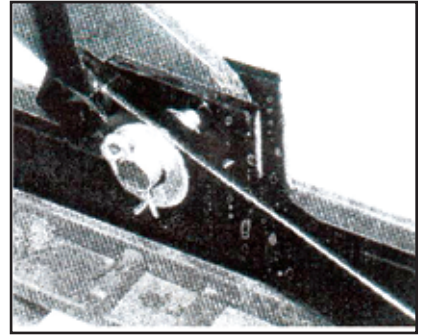

■ FIGURE 4

Raise the Front Support by hand and align the head of the Hydraulic Ram with the Holes in the middle of the Front Ram Support. Secure it with the Pin provided. Insert the Pulling Handle into the hole on the outside of the Front Ram Support and secure it with a Pin.

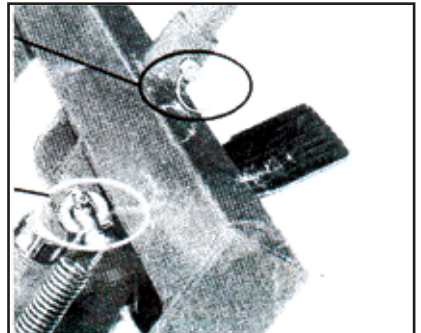

■ FIGURE 5

This is the position used to place the jack under the load. Use the Pulling Handle to move the jack. Use extreme care when moving the jack with a load.

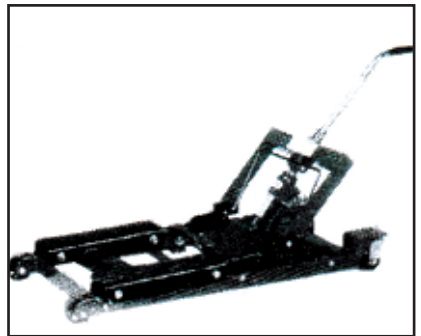

■ FIGURE 6

This photo shows the foot pedal. Pump the foot pedal to raise the load. Also shown is the Safety Bar. When the load is fully raised, secure it by engaging this bar on to the raised tabs of the frame. This will prevent accidental lowering. Before lowering the load, make sure to release this bar from its position.



■ FIGURE 7

To lower the jack, disengage the safety bar and press the Release Valve Pedal SLOWLY.

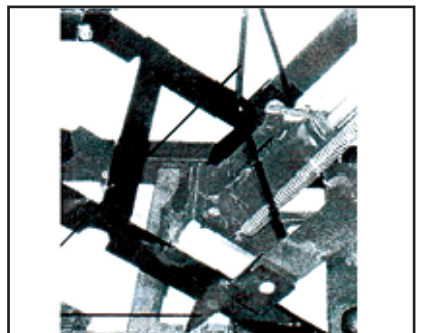

CARE AND MAINTENANCE

Care Instructions

- Visual inspections shall be made before each use of the jack by checking for abnormal conditions such as cracked welds, leaks and damaged loose or missing parts.
- Other inspections shall be made per product operating instructions.
- Each jack shall be inspected immediately if it is believed to have been subjected to an abnormal load or shock.
- Owners and or operators should be aware that repair of this equipment may require special knowledge and facilities.
- It is recommended that an annual inspection of the jack be made and that any defective parts, decals on safety labels or signs be replaced with manufacture's or supplier's specified parts.
- Any jack that appears to be damaged in any way, is found to be worn, or operates abnormally shall be removed from service until repaired.
- Because of the potential hazards associated with this type of equipment, no alterations shall be made to the product.

TROUBLESHOOTING

Your Cummins product was constructed with quality			
Does not lift load	●	●	●
Does not hold load			●
Does not lift to full height	●	●	
Pump feels “spongy” under load	●	●	
Handle raises under load			●
Handle lowers under load			●
	The power unit may be low on fluid. With the jack on a leveled surface and in the down position, remove the filter plug and add clean hydraulic jack fluid to the level of the filter hole.	The power unit may have trapped air. Open the release valve a minimum of two full turns. Pump the handle a minimum of 20 strokes to purge the air from the system.	Valves may not be closing properly. To seal the valves: a)Close the release valve. b)With the ram fully lowered, manually lift the boom as high as possible. c)Open the release valve and allow the boom to descent to the lowered position.

NOTE

Problems listed above with more than ones solution may have a combination of causes. Please be sure that all solutions listed for each problem have been checked to eliminate the possibility of further trouble.

EXPLODED DIAGRAM & PARTS LIST

Exploded Diagram

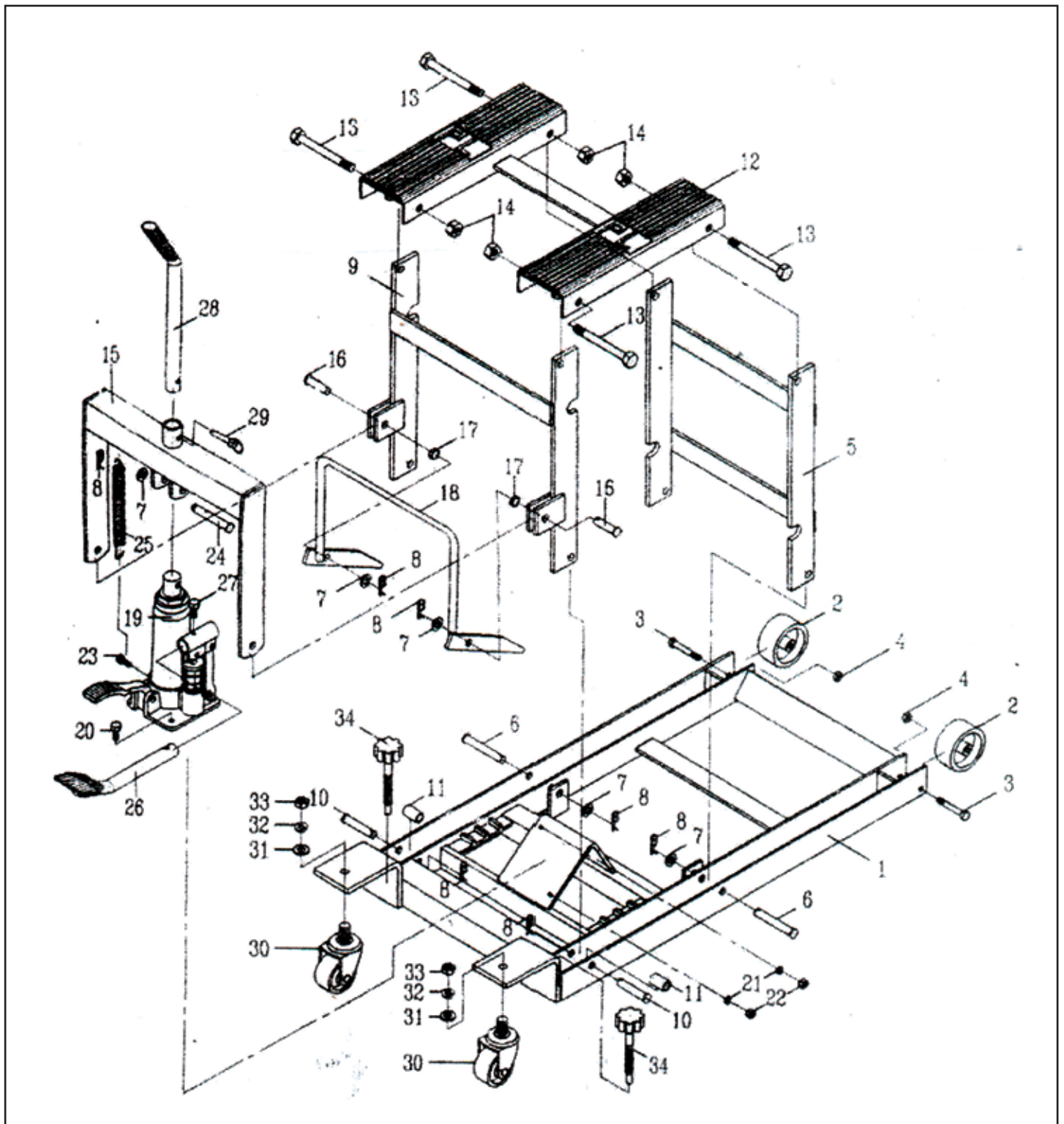

EXPLODED DIAGRAM & PARTS LIST

Parts List

NO	Description	Qty
1	Base	1
2	Wheels	2
3	Bolt 3/8" x 63 L	2
4	Lock Nut 3/8"	2
5	Front Strut	1
6	Pin (1)	2
7	Washer ø12	5
8	R-Pin ø2.2	7
9	Back Strut	1
10	Pin (2)	2
11	Bushing	2
12	Saddle	1
13	Bolt M12 x 115L	4
14	Lock Nut M12	4
15	Pulling Rod Assembly	1
16	Pin (3)	2
17	Bushing	2
18	Stop Bar	1
19	Jack	1
20	Bolt 5-16" x 25L	2
21	Spring Washer ø 5/16"	2
22	Nut 5/16"	1
23	Bolt M6 x 20L	1
24	Pin (4)	1
25	Spring	1
26	Foot Pedal	1
27	Bolt 5/16" x 10L	1
28	Handle	1
29	Pin ø7.8 x 40L	1
30	Caster Assembly	2
31	Washer ø12	2
32	Spring Washer ø1/2"	2
33	Nut 1/2"	2
34	Side Tilt Screw	2