

SAFETY WARNINGS AND PRECAUTIONS

WARNING: When using tool, basic safety precautions should always be followed to reduce the risk of personal injury and damage to equipment. Read all instructions before using the tool!

- **Work area conditions.** Cluttered areas invite injuries.
- **Additional work area conditions.** Do not use machines or power tools in damp or wet locations. Do not expose to rain. Keep work area well lighted.
- **Keep children away.** Children must never be allowed in the work area. Do not let them handle machines, tools or extension cords.
- **Store idle equipment.** When not in use, tools must be stored in a dry location to inhibit rust. Always lock up tools and keep out of reach of children.
- **Use the right tool for the job.** Do not attempt to force a small tool or attachment to do the work of a larger industrial tool. There are certain applications for which this tool was designed. It will do the job better and more safely at the rate for which it was intended. Do not modify this tool and do not use this tool for a purpose for which it was not intended.
- **Dress properly.** Do not wear loose clothing or jewelry as they can be caught in moving parts. Protective, electrically non-conductive clothes and non-skid footwear are recommended when working. Wear restrictive hair covering to contain long hair.
- **Use eye protection.** Always wear ANSI approved impact safety glasses underneath a full face shield during use. Also, wear heavy duty work gloves.
- **Do not overreach.** Keep proper footing and balance at all times. Do not reach over or across running machines.
- **Maintain tools with care.** Keep tools sharp and clean for better and safer performance. Follow instructions for lubricating and changing accessories. The handles must be kept clean, dry, and free from oil and grease at all times.
- **Remove adjusting keys and wrenches.** Check that keys and adjusting wrenches are removed from the tool or machine work surface before starting work.
- **Stay alert.** Watch what you are doing, use common sense. Do not operate any tool when you are tired.
- **Check for damaged parts.** Before using any tool, any part that appears damaged should be carefully checked to determine that it will operate properly and perform its intended function. Any part that is damaged should be replaced.
- **Replacement parts and accessories.** When servicing, use only identical replacement parts. Use of any other parts will void the warranty. Only use accessories intended for use with this tool. Approved accessories are available from Cummins Industrial Tools.
- **Do not operate tools if under the influence of alcohol or drugs.** Read warning labels on prescriptions to determine if your judgment or reflexes are impaired while taking drugs. If there is any doubt, do not operate the tool.

WARNING: The warnings, cautions, and instructions discussed in this instruction manual can not cover all possible conditions and situations that may occur. It must be understood by the operator that common sense and caution are factors which can not be built into this product, but must be supplied by the operator.

INSPECTION

- Visual inspection should be made before each use of the engine stand.
- Any engine stand which appears to be damaged in any way, is found to be badly worn, or operated abnormally must be removed from service.
- If the engine stand is accidentally subjected to an abnormal load or shock it must be inspected by the manufacturer immediately.
- It is recommended that an annual inspection of the engine stand be made and that any defective parts, decals, or warning labels be replaced with manufacturer's specified parts.

ASSEMBLY INSTRUCTIONS

- Attach four 3" swivel casters (#17) to the legs (#18) and rear beam (#16) using nuts (#14) and flat washers (#15).
- Insert each leg (#18) into the tube of rear beam (#16), put the main post (#19) to the center between the tubes of rear beam and secure the main post and two legs together with double end stud (#21), nuts (#20) and bushings (#22).
- Attach the top of support straps (#12) to the main post (#19) using bolt (#9), nut (#11) and flat washer (#10). And then connect the end of supports to base frame using bolts (#13), nuts (#11) and flat washers (#10).
- Insert the engine mounting plate (#2) through the tube at the top of the main post Rotate the plate till one of the holes in the inner tube is aligned with a hole in the outer tube and insert the ringed pin (#8).
- Insert the handle (#7) through the hole in the turning plate tube which protrudes from the top off the main post.
- Attach the shifting stands (#1) to the rotating head (#2) using bolts (#3), flat washers (#4) and nuts (#5).

NOTE: Check all bolts for tightness before operating.

EXPLODED DIAGRAM & PARTS LIST

Exploded Diagram

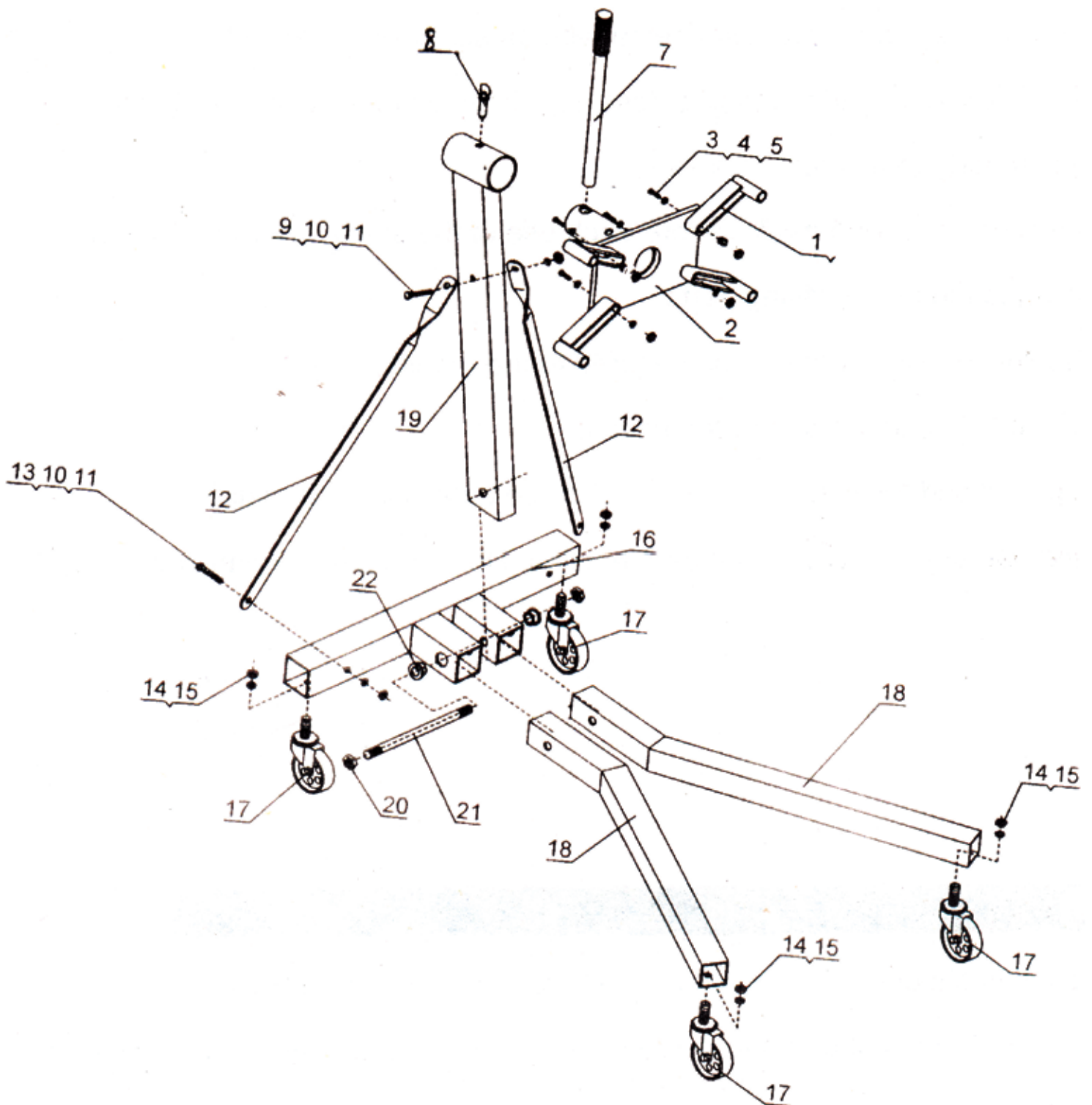

Parts List

NO	DESCRIPTION	QTY
1	Shifting Stand	4
2	Turning Plate	1
3	Bolt M14×55	4
4	Flat Washer Ø14	8
5	Nut M14	4
7	Handle	1
8	Pin	1
9	Bolt M10×65	1
10	Flat Washer Ø10	3
11	Nut M10	3
12	Support Strap	2
13	Bolt M10×80	2
14	Nut M12	4
15	Flat Washer Ø12	4
16	Rear Beam	1
17	3"SwivelCaster	4
18	Leg	2
19	Main Post	1
20	Nut M16	2
21	Double End Stud	1
22	Bushing	2