

Assembly & Instruction Manual ITEM 3180

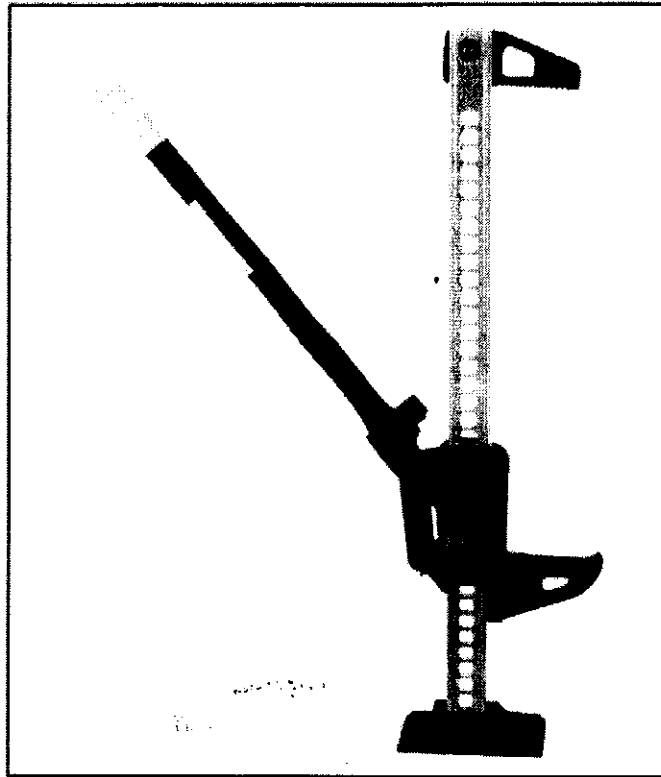

Done

48" FARM JACK

THANK YOU FOR BUYING CUMMINS INDUSTRIAL TOOLS
You can purchase additional items at
www.cumminstools.com

SAVE THIS MANUAL FOR FUTURE REFERENCE



Customer Service Postal Address:
1290 35 Road
Minden, NE 68959
Voice: 1-(308) 832-2070
Fax 1-(308) 832-2069

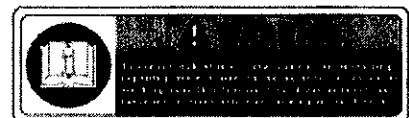

Your new 48" Farm Jack has been engineered and manufactured to Cummins Industrial Tools high standards for dependability, ease of operation, and operator safety. Pay close attention to the Rules for Safe Operation, Warnings, and Cautions. If you use your machine properly and only for what it is intended, you will enjoy years of safe, reliable service.

SAFETY WARNINGS AND PRECAUTIONS

WARNING: When using tool, basic safety precautions should always be followed to reduce the risk of personal injury and damage to equipments. Read all instructions before using the tool!

- ~~Keep~~ **Work area conditions.** Cluttered areas invite injuries.
- ~~Observe~~ ^{Additional} **work area conditions.** Do not use machines or power tools in damp or wet locations. Do not expose to rain. Keep work area well lighted.
- **Keep children away.** Children must never be allowed in the work area. Do not let them handle machines, tools or extension cords.
- **Store idle equipment.** When not in use, tools must be stored in a dry location to inhibit rust. Always lock up tools and keep out of reach of children.
- **Use the right tool for the job.** Do not attempt to force a small tool or attachment to do the work of a larger industrial tool. There are certain applications for which this tool was designed. It will do the job better and more safely at the rate for which it was intended. Do not modify this tool and do not use this tool for a purpose for which it was not intended.
- **Dress properly.** Do not wear loose clothing or jewelry as they can be caught in moving parts. Protective, electrically non-conductive clothes and non-skid footwear are recommended when working. Wear restrictive hair covering to contain long hair.
- **Use eye protection.** Always wear ANSI approved impact safety glasses underneath a full face shield during use. Also, wear heavy duty work gloves.
- **Do not overreach.** Keep proper footing and balance at all times. Do not reach over or across running machines.
- **Maintain tools with care.** Keep tools sharp and clean for better and safer performance. Follow instructions for lubricating and changing accessories. The handles must be kept clean, dry, and free from oil and grease at all times.
- **Remove adjusting keys and wrenches.** Check that keys and adjusting wrenches are removed from the tool or machine work surface before starting work.
- **Stay alert.** Watch what you are doing, use common sense. Do not operate any tool when you are tired.
- **Check for damaged parts.** Before using any tool, any part that appears damaged should be carefully checked to determine that it will operate properly and perform its intended function. Any part that is damaged should be replaced.
- **Replacement parts and accessories.** When servicing, use only identical replacement parts. Use of any other parts will void the warranty. Only use accessories intended for use with this tool. Approved accessories are available from Cummins Industrial Tools.
- **Do not operate tools if under the influence of alcohol or drugs.** Read warning labels on prescriptions to determine if your judgment or reflexes are impaired while taking drugs. If there is any doubt, do not operate the tool.

WARNING: The warnings, cautions, and instructions discussed in this instruction manual can not cover all possible conditions and situations that may occur. It must be understood by the operator that common sense and caution are factors which can not be built into this product, but must be supplied by the operator.

OPERATING INSTRUCTIONS

Before Using The Farm Jack

Caution: Improperly using this jack is highly hazardous. Read these instructions before using the jack.

- Visually inspect the jack. Check that all moving parts ^{match}mate correctly and that no visible cracks or bends are present on the handle or the rail.
- Stabilize the load to be lifted because the Farm Jack does not stabilize the load.
- Keep all visitors and children clear of the load being raised, lowered, or pulled.

Important: Do not use a handle extender. All warranties are void if an extender is used on the handle.

Lifting A Load

Refer to Figure 1 while following these steps:

- **Step 1.** Place the jack on a stable area to prevent shifting or slipping.
- **Step 2.** Put the reversing switch in the up position to raise loads.
- **Step 3.** Place the jack's lifting nose completely under the object you want to lift, the ratcheting mechanism lets the lifting nose, saving you from having to pump the handle.
- **Step 4.** Slowly pump the handle to raise the load. Always keep a firm grip on the handle while operating the jack.
- **Step 5.** After the load is raised to the desired height, insert a 1/2 inch bolt (not included) through the hole in the steel rail immediately below the lifting mechanism.
- **Step 6.** Insert additional supports to make sure the load is properly supported at the lift point to prevent shifting.

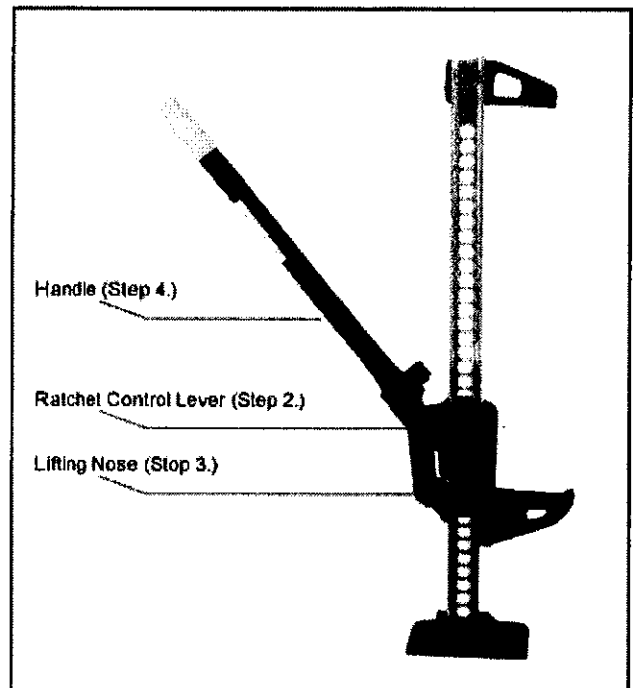

CAUTION: (Refer to Step 5) Dynamic loading may under certain circumstances create a situation where the actual weight being held or lifted is far in excess of jack or bolt capacity. **DO NOT** drop weight onto the lifting nose, as this may shear the 1/2" bolt or cause the jack to fail. *DK*

OPERATING INSTRUCTIONS

CAUTION: Follow these precautions while working with raised loads:

- Never work under a raised load.
- Never push a lifted load off the jack.
- Never attempt to repair the jack when it is under a load.

Lowering A Load

WARNING: When using tools, basic safety precautions should always be followed to reduce the risk of personal injury.

- **Step 1.** Put the handle in the upright position before tripping the reversing latch to lower the load.
- **Step 2.** Place the reversing switch in the down position.
- **Step 3.** Slowly pump the handle to lower the load.

Note: To lower loads one raised level at a time, the jack must be loaded with 110 lb (50 kg) or more. Otherwise, the lifting nose will drop.

Maintaining The Farm Jack

- Keep the jack clean and oiled. The front and back of the rail must be kept rust free.
- If any part of the jack fails, do not use until it is completely repaired and checked by a professional.

PART LIST

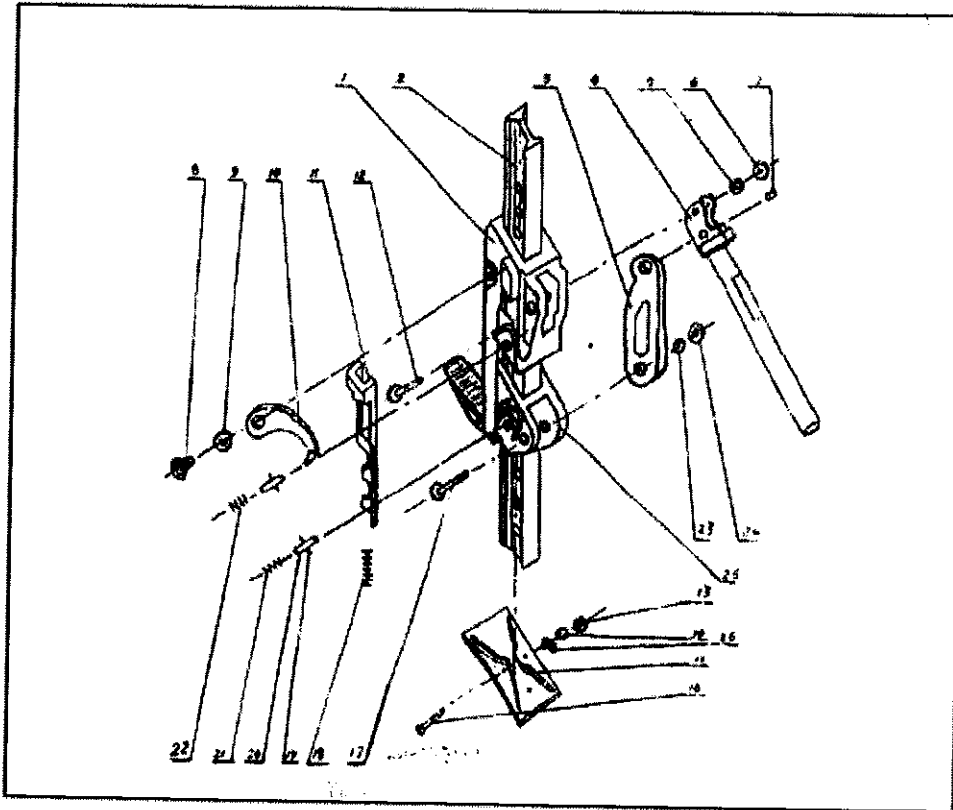

No.	Name	Quantity	No.	Name	Quantity
1	Large Runner	1	14	Washer	1
2	Steel Bar	1	15	Base	1
3	Connecting Rod	1	16	Screw Bolt	1
4	Rocker	1	17	Screw Bolt	1
5	Washer	1	18	Spring	1
6	Nut	1	19	Pin	2
7	Pin	1	20	Reverse Rod	2
8	Screw	1	21	Spring	1
9	Washer	1	22	Spring	1
10	Reversing Latch	1	23	Washer	1
11	Reversing Switch	1	24	Nut	1
12	Screw Bolt	1	25	Small Runner	1
13	Nut	1	26	Spring Washer	1