



Assembly & Instruction Manual

ITEM 3134

VENDOR: A | SERIES: 1



20 GALLON PARTS WASHER

THANK YOU FOR BUYING CUMMINS INDUSTRIAL TOOLS
You can purchase additional items at
www.cumminstools.com

SAVE THIS MANUAL FOR FUTURE REFERENCE



Customer Service Postal Address:
1290 35 Road
Minden, NE 68959
Voice: 1-(308) 832-2070
Fax: 1-(308) 832-2069

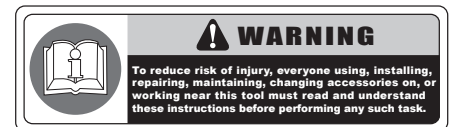

Your new 20 Gallon Parts Washer has been engineered and manufactured to Cummins Industrial Tools high standards for dependability, ease of operation, and operator safety. Pay close attention to the Rules for Safe Operation, Warnings, and Cautions. If you use your machine properly and only for what it is intended, you will enjoy years of safe, reliable service.

SAFETY WARNINGS AND PRECAUTIONS

WARNING: When using tool, basic safety precautions should always be followed to reduce the risk of personal injury and damage to equipment. Read all instructions before using the tool!

- **Work area conditions.** Cluttered areas invite injuries.
- **Additional work area conditions.** Do not use machines or power tools in damp or wet locations. Do not expose to rain. Keep work area well lighted.
- **Keep children away.** Children must never be allowed in the work area. Do not let them handle machines, tools or extension cords.
- **Store idle equipment.** When not in use, tools must be stored in a dry location to inhibit rust. Always lock up tools and keep out of reach of children.
- **Use the right tool for the job.** Do not attempt to force a small tool or attachment to do the work of a larger industrial tool. There are certain applications for which this tool was designed. It will do the job better and more safely at the rate for which it was intended. Do not modify this tool and do not use this tool for a purpose for which it was not intended.
- **Dress properly.** Do not wear loose clothing or jewelry as they can be caught in moving parts. Protective, electrically non-conductive clothes and non-skid footwear are recommended when working. Wear restrictive hair covering to contain long hair.
- **Use eye protection.** Always wear ANSI approved impact safety glasses underneath a full face shield during use. Also, wear heavy duty work gloves.
- **Do not overreach.** Keep proper footing and balance at all times. Do not reach over or across running machines.
- **Maintain tools with care.** Keep tools sharp and clean for better and safer performance. Follow instructions for lubricating and changing accessories. The handles must be kept clean, dry, and free from oil and grease at all times.
- **Remove adjusting keys and wrenches.** Check that keys and adjusting wrenches are removed from the tool or machine work surface before starting work.
- **Stay alert.** Watch what you are doing, use common sense. Do not operate any tool when you are tired.
- **Check for damaged parts.** Before using any tool, any part that appears damaged should be carefully checked to determine that it will operate properly and perform its intended function. Any part that is damaged should be replaced.
- **Replacement parts and accessories.** When servicing, use only identical replacement parts. Use of any other parts will void the warranty. Only use accessories intended for use with this tool. Approved accessories are available from Cummins Industrial Tools.
- **Do not operate tools if under the influence of alcohol or drugs.** Read warning labels on prescriptions to determine if your judgment or reflexes are impaired while taking drugs. If there is any doubt, do not operate the tool.

WARNING: The warnings, cautions, and instructions discussed in this instruction manual can not cover all possible conditions and situations that may occur. It must be understood by the operator that common sense and caution are factors which can not be built into this product, but must be supplied by the operator.

INSTRUCTIONS

Specifications

- Overall Dimensions 30-3/4" x 21-3/4" x 35-3/4"
- Tank Dimensions 29-7/8" x 20-3/4" x 10-8/10"
- Max Solvent Capacity 20 Gallons
- Max Pump Output 20L / Min
- Gross Weight 28 Kgs

Assembly Instructions

- Step 1. Remove machine from carton and inspect for any visual damage.
- Step 2. Remove parts inside the machine.
- Step 3. Lay clean and hard cardboard on the floor and lay machine on its lid.
- Step 4. Mount four legs on brackets with M6x16 screws and M6 nut.

Note: Do not tightening.

- Step 5. Place lower shelf between legs with flat surface up and attach to legs with M6x16 screws and M6 nuts.
- Step 6. With legs press tight against lower shelf, tighten all screws to lower shelf.
- Step 7. Tighten all the screws installed in step 4.
- Step 8. Stand machine up, be careful to hold lid closed.
- Step 9. Put work shelf and basket into the machine.
- Step 10. Mount pump assembly into slot on the side of the machine then place filter screen in position.
- Step 11. Plug machine into standard 110V/60Hz grounded outlet and fill with proper amount of fluid.
- Step 12. Turn switch on. Fluid should now be flowing from the flexible spigot.

PARTS LIST

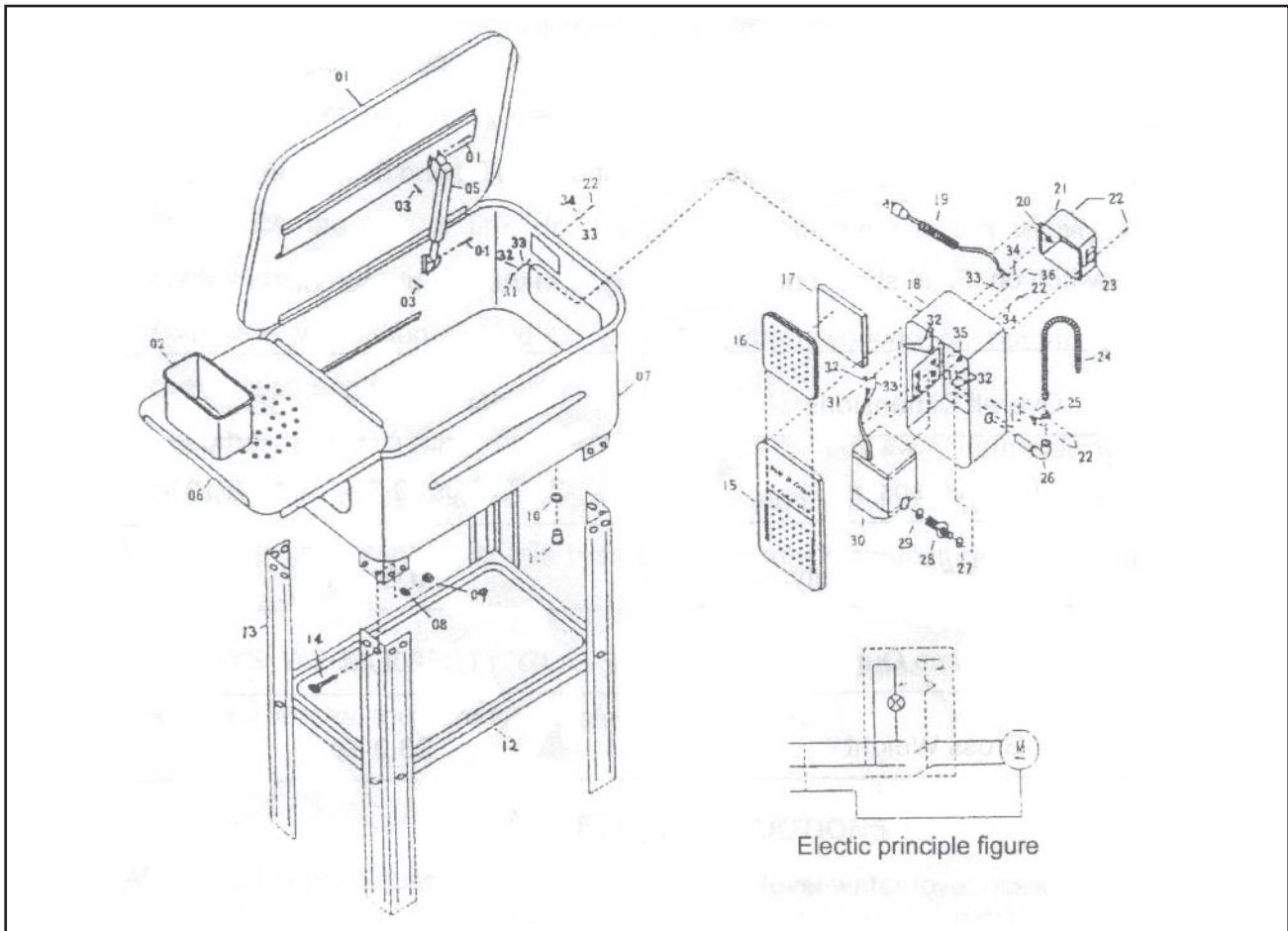

No.	Description	Qty	No.	Description	Qty
1	Cover	1	19	Cable And Plug	1
2	Work Basket	1	20	Strain Relief	1
3	Spring Pan	2	21	Switch Box	6
4	Pin	2	22	Screw	1
5	Safety Plate	1	23	Switch	1
6	Work Shelf	1	24	Flexible Pipe	1
7	Body	1	25	Elbow Seat	1
8	Spring Washer	24	26	Elbow	1
9	Nut	24	27	Plastic Washer	1
10	O-Ring	1	28	Spigot	1
11	Plug	1	29	Sealring	1
12	Shelf	1	30	Pump	1
13	Leg	4	31	Nut	7
14	Pan Screw	24	32	Spring Washer	7
15	Pump Housing Cover	1	33	Dentiform Washer	4
16	Fliter Cover	1	34	Flat Washer	2
17	Screen	1	35	Rubber Sheath	1
18	Pump Housing	1	36	Hex Screw	1