



Assembly & Instruction Manual

ITEM 3131

VENDOR: A | SERIES: 1



3 TON JACK STANDS

THANK YOU FOR BUYING CUMMINS INDUSTRIAL TOOLS
You can purchase additional items at
www.cumminstools.com

SAVE THIS MANUAL FOR FUTURE REFERENCE



Customer Service Postal Address:
1290 35 Road
Minden, NE 68959
Voice: 1-(308) 832-2070
Fax: 1-(308) 832-2069

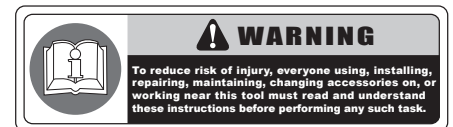

Your new 3 Ton Jack Stands has been engineered and manufactured to Cummins Industrial Tools high standards for dependability, ease of operation, and operator safety. Pay close attention to the Rules for Safe Operation, Warnings, and Cautions. If you use your machine properly and only for what it is intended, you will enjoy years of safe, reliable service.

SAFETY WARNINGS AND PRECAUTIONS

WARNING: When using tool, basic safety precautions should always be followed to reduce the risk of personal injury and damage to equipment. Read all instructions before using the tool!

- **Work area conditions.** Cluttered areas invite injuries.
- **Additional work area conditions.** Do not use machines or power tools in damp or wet locations. Do not expose to rain. Keep work area well lighted.
- **Keep children away.** Children must never be allowed in the work area. Do not let them handle machines, tools or extension cords.
- **Store idle equipment.** When not in use, tools must be stored in a dry location to inhibit rust. Always lock up tools and keep out of reach of children.
- **Use the right tool for the job.** Do not attempt to force a small tool or attachment to do the work of a larger industrial tool. There are certain applications for which this tool was designed. It will do the job better and more safely at the rate for which it was intended. Do not modify this tool and do not use this tool for a purpose for which it was not intended.
- **Dress properly.** Do not wear loose clothing or jewelry as they can be caught in moving parts. Protective, electrically non-conductive clothes and non-skid footwear are recommended when working. Wear restrictive hair covering to contain long hair.
- **Use eye protection.** Always wear ANSI approved impact safety glasses underneath a full face shield during use. Also, wear heavy duty work gloves.
- **Do not overreach.** Keep proper footing and balance at all times. Do not reach over or across running machines.
- **Maintain tools with care.** Keep tools sharp and clean for better and safer performance. Follow instructions for lubricating and changing accessories. The handles must be kept clean, dry, and free from oil and grease at all times.
- **Remove adjusting keys and wrenches.** Check that keys and adjusting wrenches are removed from the tool or machine work surface before starting work.
- **Stay alert.** Watch what you are doing, use common sense. Do not operate any tool when you are tired.
- **Check for damaged parts.** Before using any tool, any part that appears damaged should be carefully checked to determine that it will operate properly and perform its intended function. Any part that is damaged should be replaced.
- **Replacement parts and accessories.** When servicing, use only identical replacement parts. Use of any other parts will void the warranty. Only use accessories intended for use with this tool. Approved accessories are available from Cummins Industrial Tools.
- **Do not operate tools if under the influence of alcohol or drugs.** Read warning labels on prescriptions to determine if your judgment or reflexes are impaired while taking drugs. If there is any doubt, do not operate the tool.

WARNING: The warnings, cautions, and instructions discussed in this instruction manual can not cover all possible conditions and situations that may occur. It must be understood by the operator that common sense and caution are factors which can not be built into this product, but must be supplied by the operator.

OPERATING INSTRUCTIONS

Specifications

- **Capacity** 3 Tons *
- **Minimum Height** 11 1/2"
- **Maximum Height** 16 7/10"
- **Base Dimensions** 7" x 7 3/4"
- **Saddle Dimensions** 3 1/2" x 1"
- **Weight** 6 3/5 lbs each

* Evenly distributed over two jack stands

Unpacking

- When unpacking, check to make sure the parts listed on page 4 are included. If any parts are missing or broken, please call Cummins Industrial Tools at the number on the cover of this manual as soon as possible.

Assembly

Refer to Assembly Drawing on page 4.

- Take the Ratchet Bar (2) and face the ratchet edge toward the front of the Jack. The Stopper (3) is on the front. Caution: The Ratchet Bar (2) is heavy; be aware of potential injury to fingers and toes if the Ratchet Bar (2) is dropped.
- On the opposite side of the Handle (7), on the Jack, is the Screw (5). Using a Hex Wrench (not included), loosen the Screw (5) until it does not interfere with the bar being inserted. Lift the Handle (7) and lower the Ratchet (2) into the Jack. Make sure it is completely lowered.

Caution: Be alert to pinching danger when lowering the Ratchet Bar (2).

- Tighten the Screw (5) Make sure the Screw (5) is tightened enough to keep the Ratchet Bar (2) from coming out of the Jack.

Warning: Before using the Jack Stands you must check to see that the Screw (5) is holding in the Jack. Check to make sure the Ratchet Bar (2) cannot be pulled up and out of the Jack.

- Repeat the entire procedure with the other Jack Stand.

Warning: Never crawl under the vehicle when supporting it with Jack Stands.

Warning: Only use the Jack Stands on a dry, level, flat surface, which is free of grease or debris. Only use in pairs. Never use one Jack Stand to support vehicle.

OPERATING INSTRUCTIONS

Supporting A Vehicle

- Make sure the vehicle does not exceed the 3 ton capacity of the Jack Stands. **Note: That is 3 tons of evenly distributed weight per pair of Jack Stands. You must evenly distribute the weight or the Jack Stands will fall, causing severe injury or death. Only apply the load vertically.**

Warning: If a vehicle drops on the Jack Stands (even if it is under the weight capacity limit), the principle of “dynamic loading” takes affect. The force of the weight falling will cause the Jack Stands to fail. A vehicle weighing much less than the 3 ton capacity will cause the Jack Stands to fail.

Warning: Never attempt to move the Handle (7) when the jack stands are supporting a vehicle. Note: Shear pin is designed to shear in the event the user attempts to move the Handle (7) while supporting weight. If the pin shears, do not use the jack stands again until the shear pin is replaced by a qualified technician.

- Always examine your Jack Stand for cracks or damage before each use. Do not use if even a minor crack appears. Discard Jack Stand if a crack appears.
- Raise the Handle (7) on each Jack Stand to completely lower the Ratchet Bar (2).
- If your are raising only one end of the vehicle, block the that remain on the ground.
- Following the instructions in your floor jack manual, raise your vehicle to just above the minimum height of your Jack Stands.
- Slide your Jack Stands to the proper position points referred to in the vehicle owner’s manual. Make sure the Jack Stands are on the same point on each side of the vehicle. Move the Handle (7) up, and raise the Jack Stands until they are just below the jack contact point on the vehicle. Center the load on the Saddle of the Ratchet Bar (2). Press the Handle (7) down to release the Ratchet Bar (2) so that ratchet catches on the Stopper (3). Gently lower the vehicle with the floor jack. It may drop down a very small amount until the ratchet catches on the Stopper (3). Repeat on other side.

Note: Make sure both of the Jack Stands are at the same height!

- Gently rock the vehicle to determine if is stable. If not, raise the vehicle and reposition the Jack Stands.

Removing The Jack Stands

- Raise the vehicle with a floor jack to take the load off of the Jack Stands.
- Raise the Handle (7) on the Jack Stands and lower the Ratchet Bar (2).
- Remove the Jack Stands. Use the floor jack to safely lower the vehicle to the ground.

Note: Do not remove the tires or wheels unless absolutely necessary.

Warning: Do not use Jack Stands as a permanent stand for the vehicle. Use them only while making repairs, then immediately lower to the ground.

MAINTENANCE & PART LIST

Maintenance

- Check for cracks or damage prior to each use. Discard if cracked or damaged.
- Periodically clean the bottom of the Jacks and the top of the Ratchet Bar (2) of any dirt, grease, or debris.
- Periodically lubricate the release handle pivot points with motor oil.

Part List

No.	Description
1	Base
2	Ratchet Bar
3	Stopper
4	Pin 4 x 28
5	Screw M 8 x 14
6	Handle Cover
7	Handle

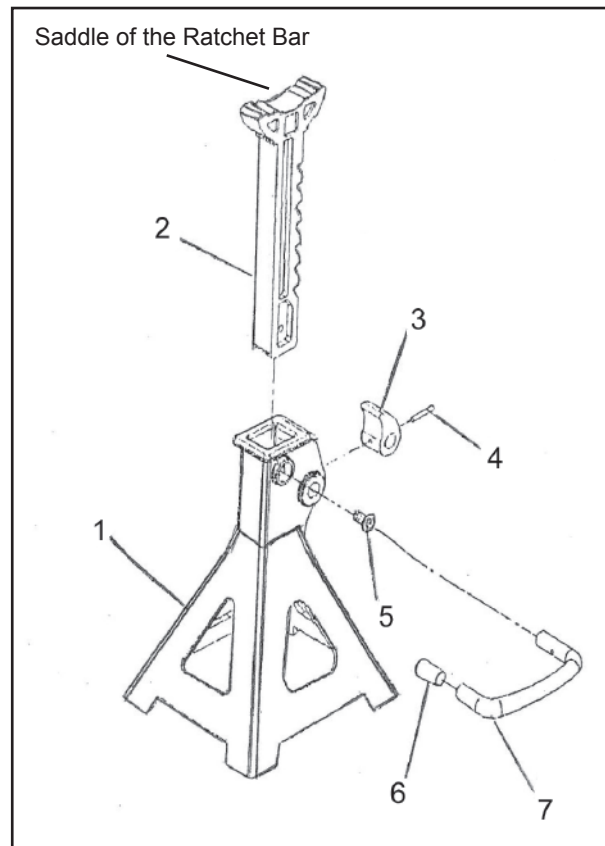
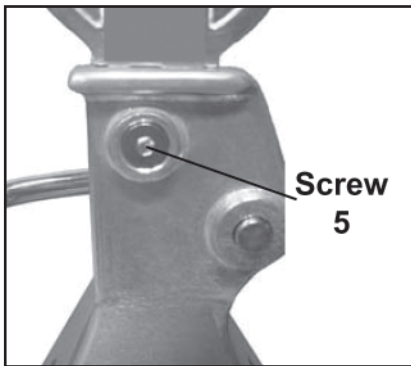

Please Read The Following Carefully

The manufacturer and / or distributor has provided the parts diagram in this manual as a reference tool only. Neither the manufacturer nor distributor makes any representation or warranty of any kind to the buyer that he or she is qualified to make any repairs to the product or that he or she is qualified to replace any parts of the product. In fact, the manufacturer and / or distributor expressly states that all repairs and parts replacement should be undertaken by certified and licensed technicians and not by the buyer. The buyer assumes all risk and liability arising out of his or her repairs to the original product or replacement parts thereto, or arising out of his or her installation of replacement parts thereto.