

TABLE OF CONTENTS

■ Introduction	1
■ General Safety Rules	2
■ Specific Safety Rules	3
■ Product Specifications	3
■ Unpacking	4
■ Operation	4-5
■ Maintenance	5
■ Exploded Diagram & Parts List	6-7

INTRODUCTION

- THIS PRODUCT has many features for making the use of this product more pleasant and enjoyable. Safety, performance, and dependability have been given top priority in the design of this product making it easy to maintain and operate.

▲ WARNING: Do not attempt to use this product until you thoroughly read and completely understand the operator's manual. Pay close attention to the safety rules, including Dangers, Warnings, and Cautions. If you use your product properly and only as intended, you will enjoy years of safe, reliable service.

- ▲ !** Look for this symbol to point out important safety precautions. It means attention!!! Your safety is involved.



▲ WARNING: The operation of any tool can result in foreign objects being thrown into your eyes, which can result in severe eye damage. Before beginning operation, always wear safety goggles or safety glasses with side shields and a full face shield when needed. We recommend Wide Vision Safety Mask for use over eyeglasses or standard safety glasses with side shields. Always wear eye protection which is marked to comply with ANSI Z87.1.

GENERAL SAFETY RULES

⚠ WARNING: When using tool, basic safety precautions should always be followed to reduce the risk of personal injury and damage to equipment. Read all instructions before using the tool!

- **Work area conditions.** Cluttered areas invite injuries.
- **Additional work area conditions.** Do not use machines or power tools in damp or wet locations. Do not expose to rain. Keep work area well lighted.
- **Keep children away.** Children must never be allowed in the work area. Do not let them handle machines, tools or extension cords.
- **Store idle equipment.** When not in use, tools must be stored in a dry location to inhibit rust. Always lock up tools and keep out of reach of children.
- **Use the right tool for the job.** Do not attempt to force a small tool or attachment to do the work of a larger industrial tool. There are certain applications for which this tool was designed. It will do the job better and more safely at the rate for which it was intended. Do not modify this tool and do not use this tool for a purpose for which it was not intended.
- **Dress properly.** Do not wear loose clothing or jewelry as they can be caught in moving parts. Protective, electrically non-conductive clothes and non-skid footwear are recommended when working. Wear restrictive hair covering to contain long hair.
- **Use eye protection.** Always wear ANSI approved impact safety glasses underneath a full face shield during use. Also, wear heavy duty work gloves.
- **Do not overreach.** Keep proper footing and balance at all times. Do not reach over or across running machines.
- **Maintain tools with care.** Keep tools sharp and clean for better and safer performance. Follow instructions for lubricating and changing accessories. The handles must be kept clean, dry, and free from oil and grease at all times.
- **Remove adjusting keys and wrenches.** Check that keys and adjusting wrenches are removed from the tool or machine work surface before starting work.
- **Stay alert.** Watch what you are doing, use common sense. Do not operate any tool when you are tired.
- **Check for damaged parts.** Before using any tool, any part that appears damaged should be carefully checked to determine that it will operate properly and perform its intended function. Any part that is damaged should be replaced.
- **Replacement parts and accessories.** When servicing, use only identical replacement parts. Use of any other parts will void the warranty. Only use accessories intended for use with this tool. Approved accessories are available from Cummins Industrial Tools.
- **Do not operate tools if under the influence of alcohol or drugs.** Read warning labels on prescriptions to determine if your judgment or reflexes are impaired while taking drugs. If there is any doubt, do not operate the tool.

⚠ WARNING: The warnings, cautions, and instructions discussed in this instruction manual can not cover all possible conditions and situations that may occur. It must be understood by the operator that common sense and caution are factors which can not be built into this product, but must be supplied by the operator.

SPECIFIC SAFETY RULES

- 1- Do not use this product with the car/ truck/ motorcycle engine running.
- 2- Do not use this product on high pressure tires (large trucks, trailers, tractors, etc.)
- 3- Do not exceed the tire air pressure recommended by the manufacturer.
- 4- Do not leave this product unattended while the unit is running.
- 5- Do not use this product continuously for more than 15 minutes. Allow this product to cool approximately 5 minutes after inflating a tire or other inflatable.
- 6- Inflatable items constructed of soft materials (balls, beach toys, air mattresses, rubber rafts, etc.) will not usually show manufacturer recommended air pressure. Be carefully to make sure you do not over inflate.
- 7- To avoid dangerous oncoming traffic, always use this product as far away from the roadside as possible.
- 8- Always use a tire pressure gauge to check the actual pressure in tires.
- 9- When using the Blow Gun Nozzle accessory, always point the Nozzle away from your body and away from others.

SPECIFICATIONS

ITEM	DESCRIPTION
Construction	Body: Polystyrene Motor Components: Steel Air Hose & Hose Adapter: Rubber/ Nylon/ Steel
Finish	Black/ Clear Polystyrene
Max. Pressure	300 P.S.I
Power Source	12 Volts DC
Power Plug Type	Cigarette Lighter Adapter
Hose Length	25-1/2"
Nozzle Type	Locking Tire Chuck Needle Ball Valve Blow Gun Nozzles (quantity: 2)
Power Cord Length	10 Ft.
Gauge Markings	0-300 P.S.I (In Black) 0-20 K.P.A. x 100 (In Red)

UNPACKING

INSTRUCTIONS

When unpacking the tool:

- Carefully remove the tool and accessories from the box.
- Make sure that all items listed in the packing list are included.
- Inspect the tool carefully to make sure no breakage or damage occurred during shipping.
- Do not discard the packing material until you have carefully inspected and satisfactorily operated the tool.

⚠ WARNING: If any part are missing do not operate the tool until the missing parts are replaced. Failure to do so could result in possible serious personal injury.

OPERATION

To Inflate Automotive Tires

- 1- Remove the valve cap from the valve stem of the tire.
- 2- Attach the Universal Hose Adapter to the tire valve stem with the locking lever (Figure A) in the up position. Check to make sure the Universal Hose Adapter is pressed down completely over the threads of the valve stem.
- 3- When the Universal Hose Adapter is firmly in place, press the locking lever down (Figure B) to lock onto the valve stem.
- 4- To inflate, plug the DC Power Cord into the cigarette lighter socket (Figure C). Then turn the DC Power Cord "ON/ OFF" switch to the "ON" position.
- 5- The Mini Portable Air Compressor is now ready for use.
- 6- **NOTE:** In the event the tire is totally deflated it may have separated from the tire rim. In this case, you may need to jack up the vehicle prior to inflating the tire.

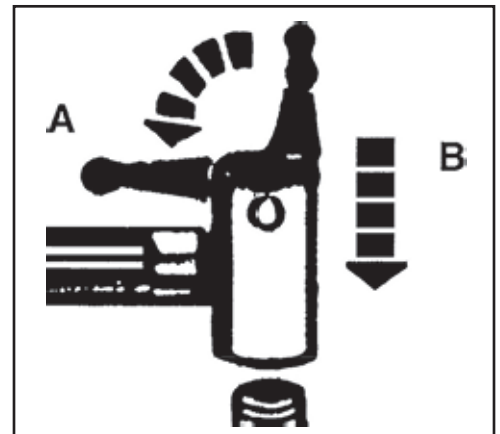

To Inflate Balls, Beach Toys, Air Mattresses, Rubber Rafts, Etc

- To inflate, insert the threaded end of the Inflation Nozzle into the Universal Hose Adapter. Lock the Inflation Nozzle in place and insert its' end into the item to be inflated.

OPERATION

To Use Blow Gun Nozzle

- Insert the threaded end of the Blow Gun Nozzle into the Universal Hose Adapter and lock the Blow Gun Nozzle in place.

MAINTENANCE

- For better and safer performance, keep all parts of this product clean and dry at all times.

EXPLODED DIAGRAM

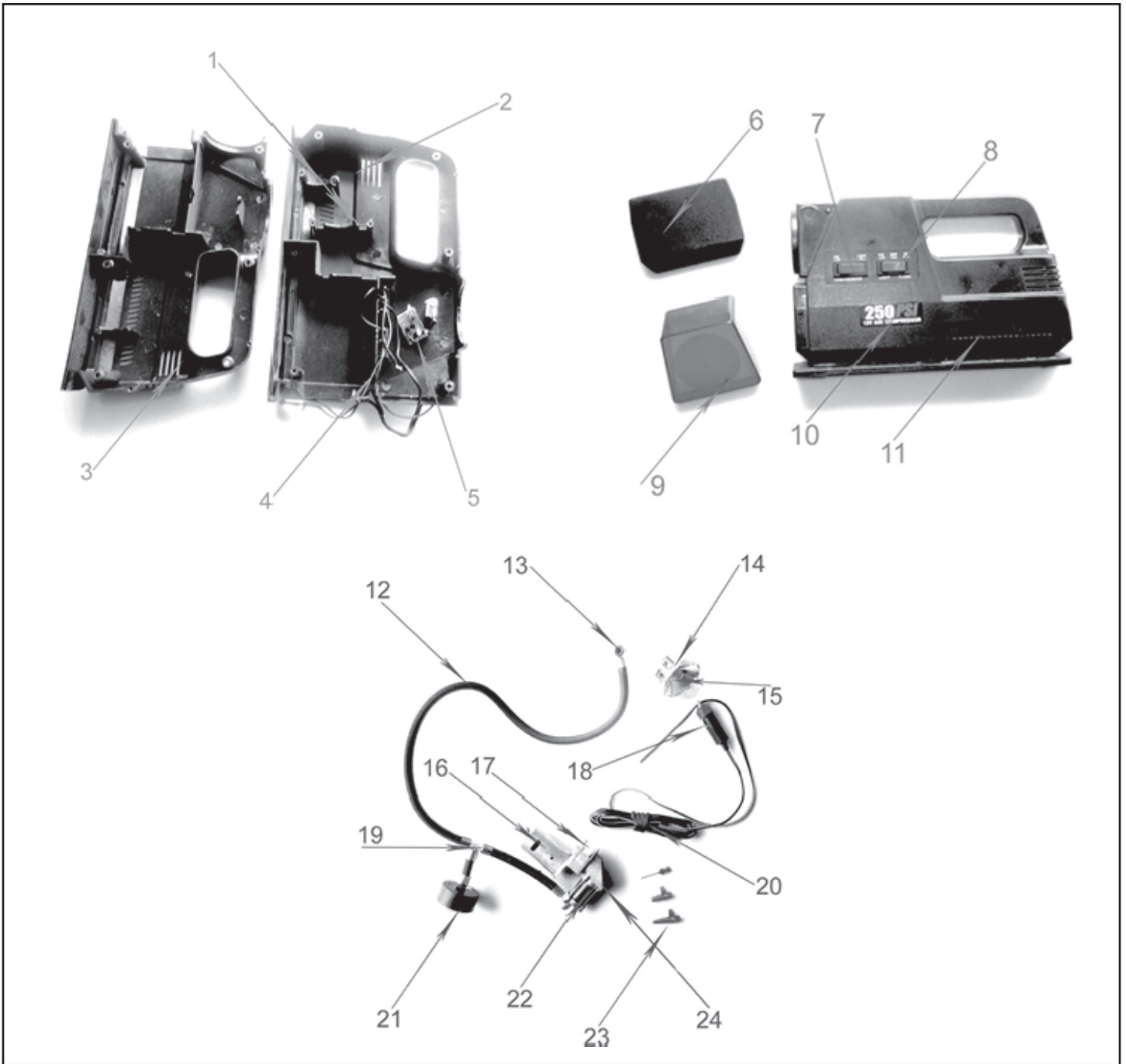

PARTS LILST

NO	DESCRIPTION
1	WITH 19 CMOS SHIP
2	ABS DOS SHELL
3	ABS DOS SHELL
4	JOINING
5	CIRCUITRY
6	COVER
7	AIR COMPRESSOR SWITCH
8	LIGHT SWITCH
9	LAMPSHADE
10	SIGN
11	ABS DOSSHELL
12	SAGUAN
13	TRACHEA
14	VALVE
15	PLASTIC- SHIMNEY
16	BULB
17	ELECTROMOTOR
18	PLASTIC- GEAR
19	THREE TIE-IN
20	ELECTRICAL WIRE
21	BAROMETER
22	STEELMAT
23	ACCESSORIES
24	BRACKET